

## ❖ CABLE ENTRY PLATE

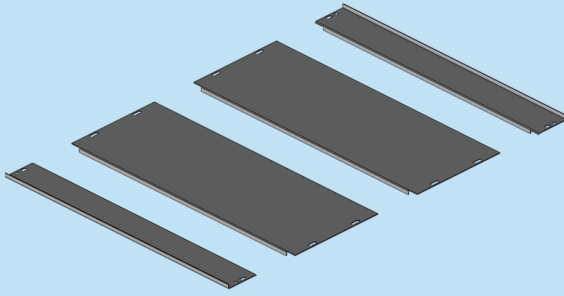

ORDER NO Standard Duty Thickness 1.5mm	ORDER NO Heavy Duty Thickness 2.0mm	TYPE	DESCRIPTION	MODULE SIZE	DIMENSIONS (WxH)mm	THICKNESS	QTY
830 112	830 113	CEP 1.1	Cable Entry Plate Set	1Mx1M	165x165	2.0mm	01 Set=2 Plates
830 122	830 123	CEP 1.2	Cable Entry Plate Set	1Mx2M	165x385	2.0mm	01 Set=3 Plates
830 132	830 133	CEP 1.3	Cable Entry Plate Set	1Mx3M	165x605	2.0mm	01 Set=4 Plates
830 142	830 143	CEP 1.4	Cable Entry Plate Set	1Mx4M	165x825	2.0mm	01 Set=5 Plates
830 182	830 182	CEP 2.1	Cable Entry Plate Set	2Mx1M	385x165	2.0mm	01 Set=2 Plates
830 193	830 194	CEP 2.2	Cable Entry Plate Set	2Mx2M	385x385	2.0mm	01 Set=3 Plates
830 202	830 203	CEP 2.3	Cable Entry Plate Set	2Mx3M	385x605	2.0mm	01 Set=4 Plates
830 212	830 213	CEP 2.4	Cable Entry Plate Set	2Mx4M	385x825	2.0mm	01 Set=5 Plates
830 252	830 253	CEP 3.1	Cable Entry Plate Set	3Mx1M	605x165	2.0mm	01 Set=2 Plates
830 262	830 263	CEP 3.2	Cable Entry Plate Set	3Mx2M	605x385	2.0mm	01 Set=3 Plates
830 272	830 273	CEP 3.3	Cable Entry Plate Set	3Mx3M	605x605	2.0mm	01 Set=4 Plates
830 282	830 283	CEP 3.4	Cable Entry Plate Set	3Mx4M	605x825	2.0mm	01 Set=5 Plates
830 322	830 323	CEP 4.1	Cable Entry Plate Set	4Mx1M	825x165	2.0mm	01 Set=2 Plates
830 332	830 333	CEP 4.2	Cable Entry Plate Set	4Mx2M	825x385	2.0mm	01 Set=3 Plates
830 342	830 343	CEP 4.3	Cable Entry Plate Set	4Mx3M	825x605	2.0mm	01 Set=4 Plates
830 352	830 353	CEP 4.4	Cable Entry Plate Set	4Mx4M	825x825	2.0mm	01 Set=5 Plates
830 362	830 363	CEP 5.1	Cable Entry Plate Set	5Mx1M	1045x165	2.0mm	01 Set=2 Plates
830 362	830 363	CEP 5.2	Cable Entry Plate Set	5Mx2M	1045x385	2.0mm	01 Set=3 Plates
830 372	830 373	CEP 5.3	Cable Entry Plate Set	5Mx3M	1045x605	2.0mm	01 Set=4 Plates
830 372	830 373	CEP 5.4	Cable Entry Plate Set	5Mx4M	1045x825	2.0mm	01 Set=5 Plates

01 Set = 02 Plates

## ❖ CABLE ENTRY PLATE MOUNTING ANGLE

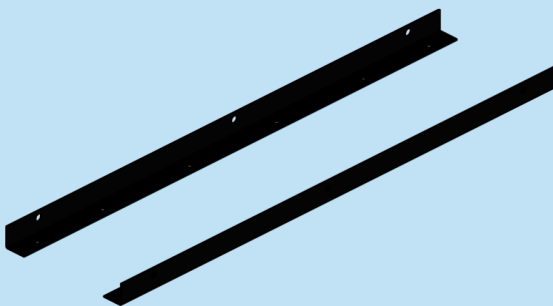

ORDER NO	TYPE	DESCRIPTION	MODULE SIZE	DIMENSIONS (WxHxD)mm	THICKNESS	QTY
830 010	CEPMA 1	Cable Entry Plate Mounting Angle 1M	1M	23.5x23.5x108.5	2.0mm	Set of 2 No
830 020	CEPMA 2	Cable Entry Plate Mounting Angle 2M	2M	23.5x23.5x328.5	2.0mm	Set of 2 No
830 030	CEPMA 3	Cable Entry Plate Mounting Angle 3M	3M	23.5x23.5x548.5	2.0mm	Set of 2 No
830 040	CEPMA 4	Cable Entry Plate Mounting Angle 4M	4M	23.5x23.5x768.5	2.0mm	Set of 2 No
830 050	CEPMA 5	Cable Entry Plate Mounting Angle 5M	5M	23.5x23.5x988.5	2.0mm	Set of 2 No

UPDATE ON	20/06/2022	REPLACE OF	27/04/2022
-----------	------------	------------	------------